

PLAN OF TYPICAL SIDEWALK WITH CURB RAMP FOR THE HANDICAPPED
(CORNER RADIUS = 12FT.)
N.T.S.

NOTE:
ANY RADIUS THAT EXCEEDS 12FT., THE CURB RAMP WIDTH WILL BE DETERMINED BY ENGINEERING DEPT.

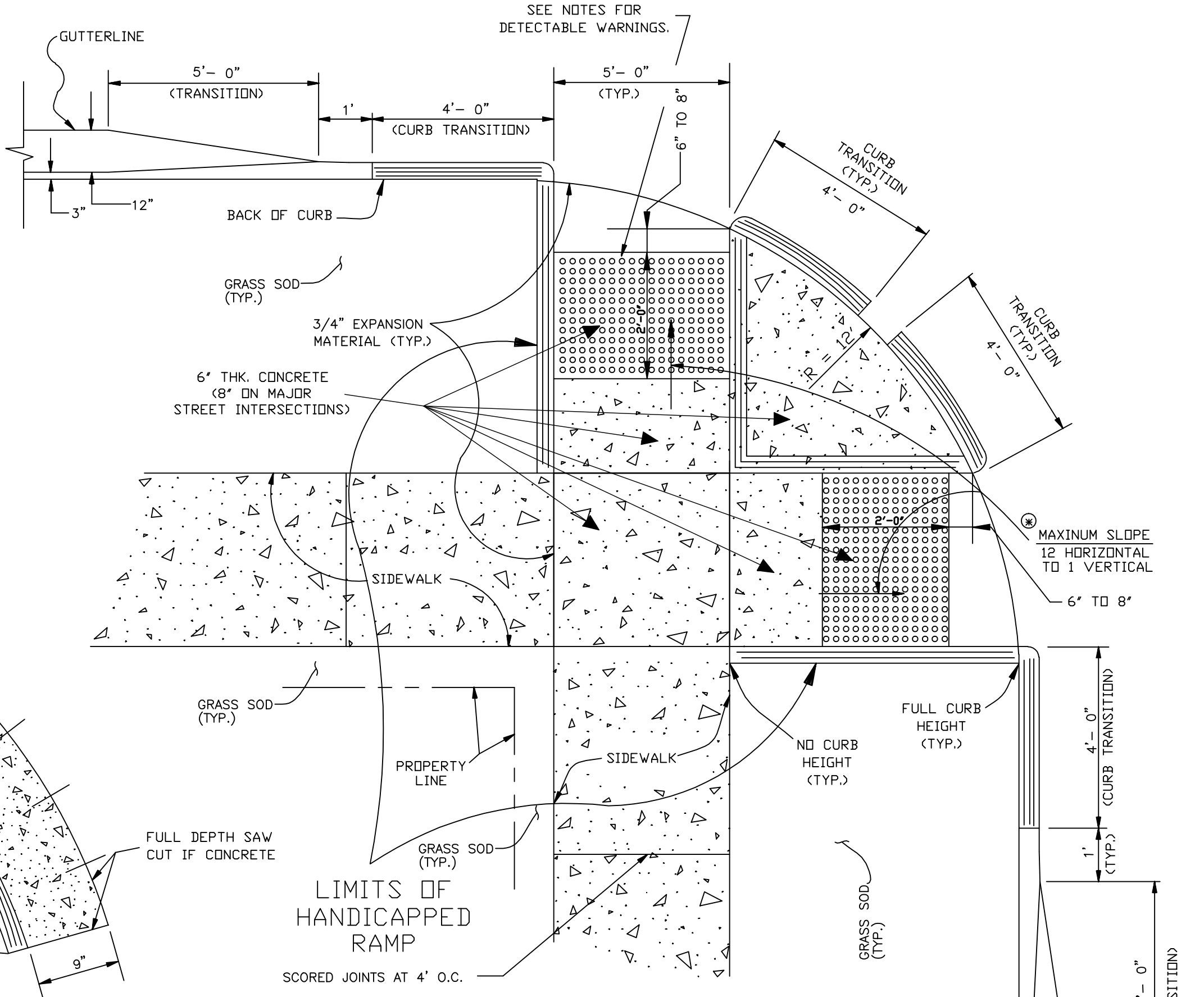

ALTERNATE #1
PLAN OF CURB RAMP FOR THE HANDICAPPED
(WITH APPROVAL OF THE DEPT. OF ENGINEERING)
(CORNER RADIUS = 12FT.)
N.T.S.

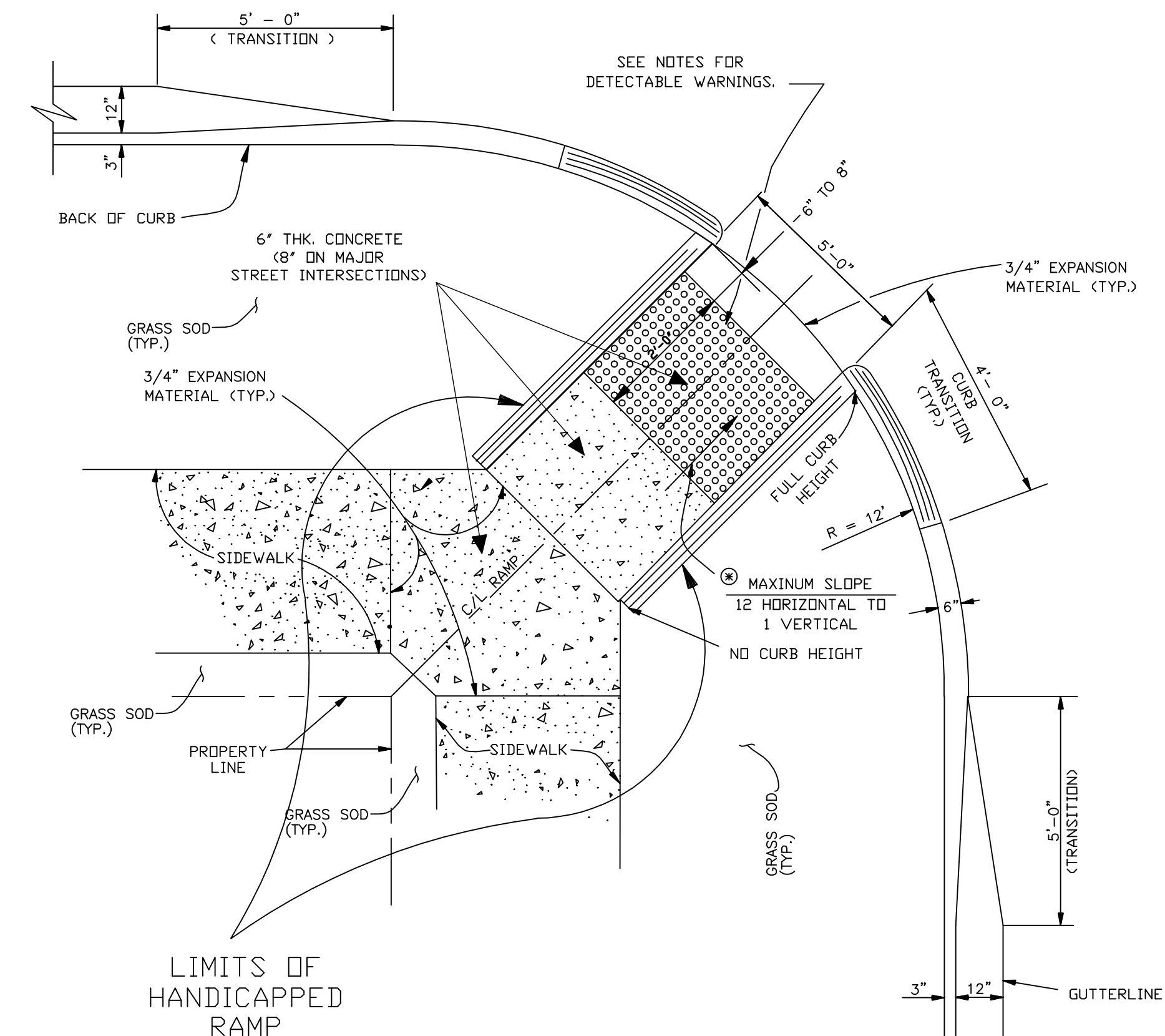

ALTERNATE #2
PLAN OF CURB RAMP FOR THE HANDICAPPED
(WITH APPROVAL OF THE DEPT. OF ENGINEERING)
(CORNER RADIUS = 12FT.)
N.T.S.

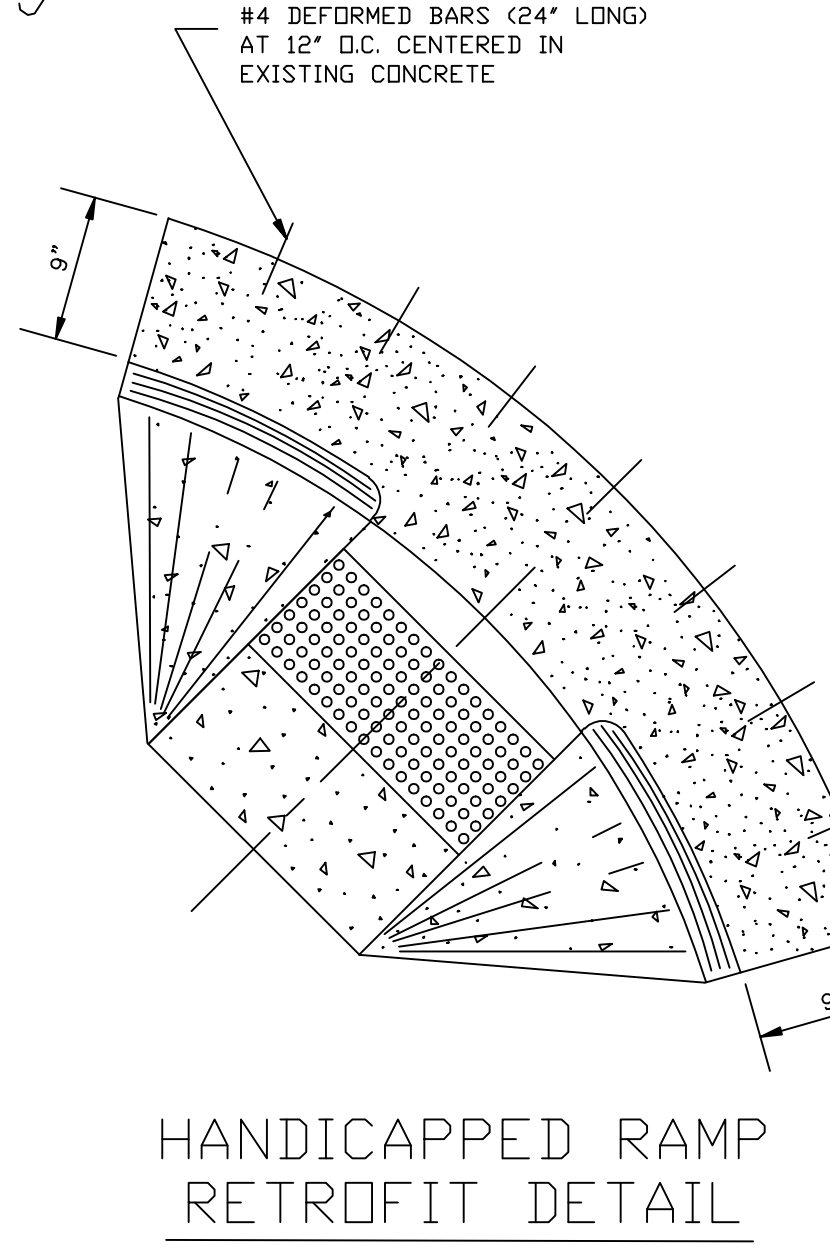

HANDICAPPED RAMP RETROFIT DETAIL

NOTE FOR HANDICAPPED RAMP CONNECTION TO EXISTING ROAD
FOR CONCRETE ROADWAY CONTRACTOR SHALL MAKE FULL DEPTH SAW-CUT TO REMOVE THE PORTION OF EXISTING ROADWAY AND INTEGRAL CONCRETE CURB WITHIN THE LIMITS SHOWN AND REPLACE WITH HANDICAPPED ACCESSIBLE CURBING. IF CURB IS NOT POURED MONOLITHICALLY, CONCRETE WILL NEED TO BE DEPRESSED THREE (3) INCHES AT CURB LOCATIONS TO ALLOW FOR CURB DOWELS.
FOR ASPHALT ROADWAY CONTRACTOR SHALL MAKE FULL DEPTH SAW-CUT TO REMOVE EXISTING CURB AND GUTTER (AND POSSIBLE ASPHALT OVERLAY), AND REPLACE WITH HANDICAPPED ACCESSIBLE CURBING. IF CURB IS NOT POURED MONOLITHICALLY WITH GUTTER, CONCRETE WILL NEED TO BE DEPRESSED THREE (3) INCHES AT CURB LOCATIONS TO ALLOW FOR CURB DOWELS.

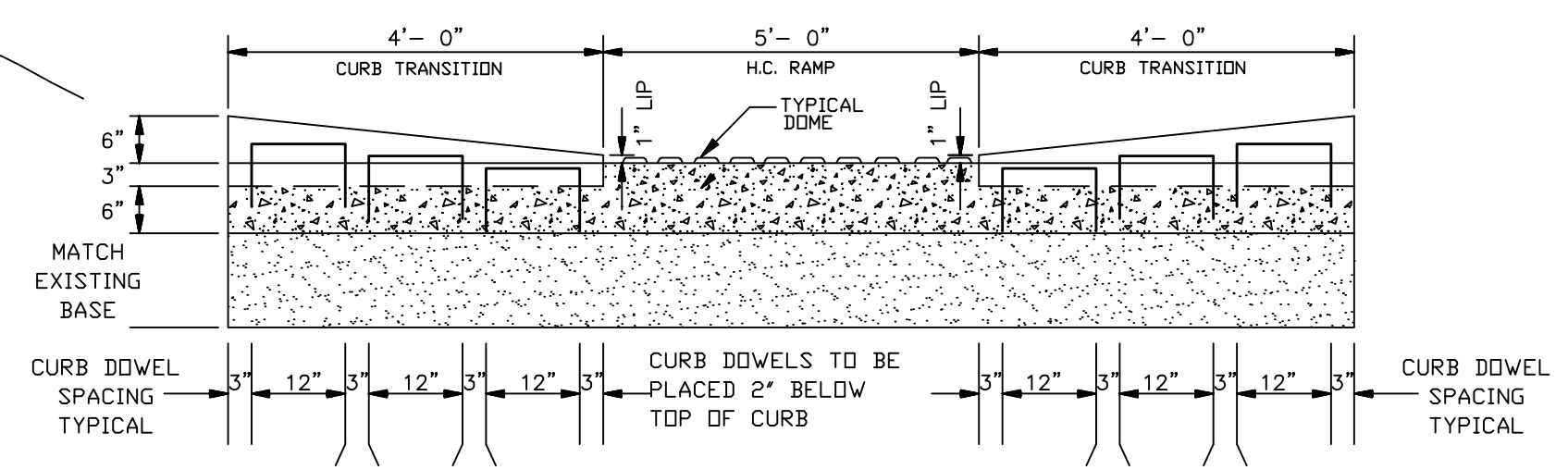

H.C. RAMP CURB DETAIL
VIEW "C - C"
N.T.S.

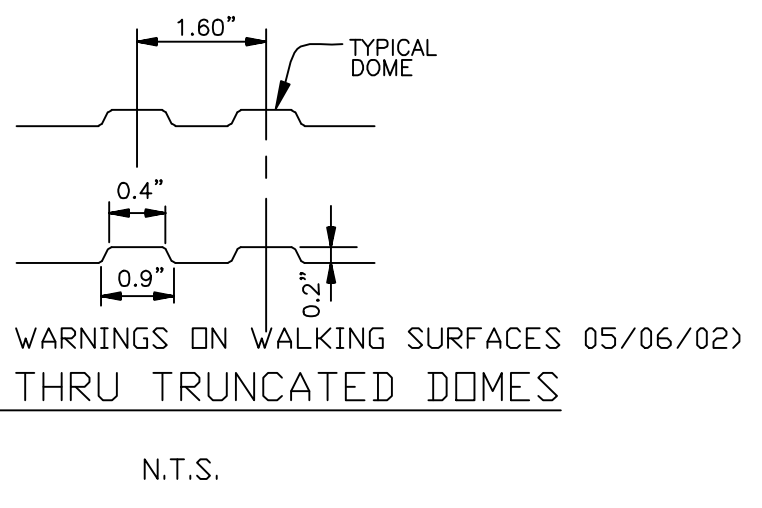

(ADAAG DETECTABLE WARNINGS ON WALKING SURFACES 05/06/02)
SECTION THRU TRUNCATED DOMES
N.T.S.

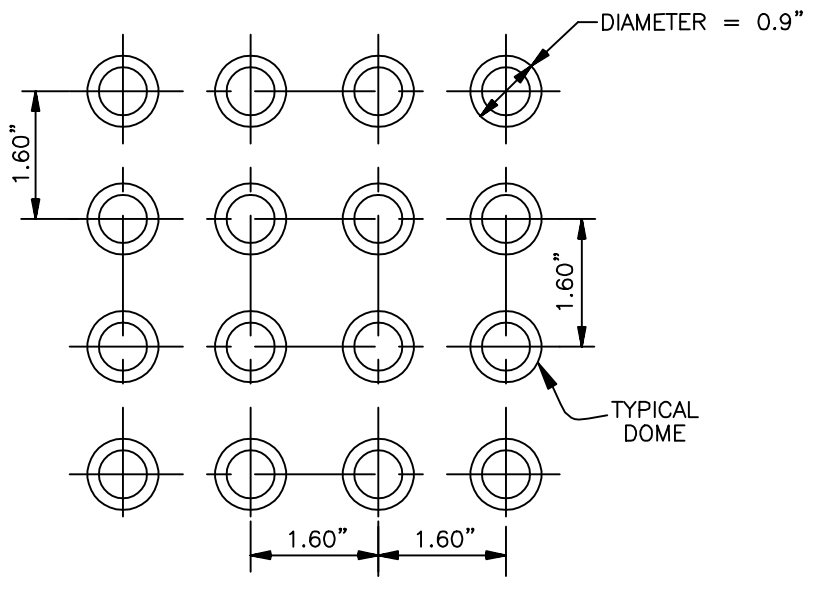

PARTIAL PLAN OF TRUNCATED DOMES
(ADAAG DETECTABLE WARNINGS ON WALKING SURFACES 05/06/02)
N.T.S.

NOTES:

- TRUNCATED DOMES IN A DETECTABLE WARNING SURFACE SHALL HAVE A BASE DIAMETER OF 0.9 INCHES (23 mm) MINIMUM TO 1.4 INCHES (36 mm) MAXIMUM, A TOP DIAMETER OF 50% OF THE BASE DIAMETER MINIMUM TO 65% OF THE BASE DIAMETER MAXIMUM, AND A HEIGHT OF 0.2 INCHES (5 mm).
- TRUNCATED DOMES IN A DETECTABLE WARNING SURFACE SHALL HAVE A CENTER-TO-CENTER SPACING OF 1.6 INCHES (41 mm) MINIMUM AND 2.4 INCHES (61 mm) MAXIMUM, AND A BASE-TO-BASE SPACING OF 0.65 INCHES (16 mm) MINIMUM, MEASURED BETWEEN THE MOST ADJACENT DOMES ON SQUARE GRID.
- TRUNCATED DOMES SURFACES SHALL CONTRAST VISUALLY WITH ADJACENT WALKING SURFACES EITHER LIGHT-ON-DARK, OR DARK ON LIGHT.
- THE MATERIAL USED TO PROVIDE CONTRAST SHALL BE AN INTEGRAL PART OF THE WALKING SURFACE. DETECTABLE WARNINGS USED ON INTERIOR SURFACES SHALL DIFFER FROM ADJOINING WALKING SURFACES IN RESILIENCY OR SOUND-ON-CANE CONTACT.
- TRUNCATED DOMES ON CURB RAMPS WITHIN THE STREET R.O.W. SHALL BE CAST-IN-PLACE, PREFABRICATED DETECTABLE WARNING UNITS INSTALLED DIRECTLY IN WET CONCRETE.
- TRUNCATED DOMES SHALL COVER AT LEAST 2 FEET IN DEPTH AND EXTEND FULL WIDTH OF THE RAMP. ANY RAMP HAVING FLARED SIDES WILL NOT BE REQUIRED TO HAVE THESE DETECTABLE WARNINGS ON THE FLARES.
- THE LIMITS OF THE MAIN SURFACE OF THE RAMP ON WHICH THE DETECTABLE WARNINGS ARE PLACED SHALL HAVE A REDDISH COLOR SIMILAR TO THAT OF 'TERRA COTTA'. THE COLOR MUST BE APPROVED BY JEFFERSON PARISH DEPARTMENT OF ENGINEERING.
- STAMPING OF TRUNCATED DOMES WITHIN THE R.O.W. WILL NOT BE ALLOWED.

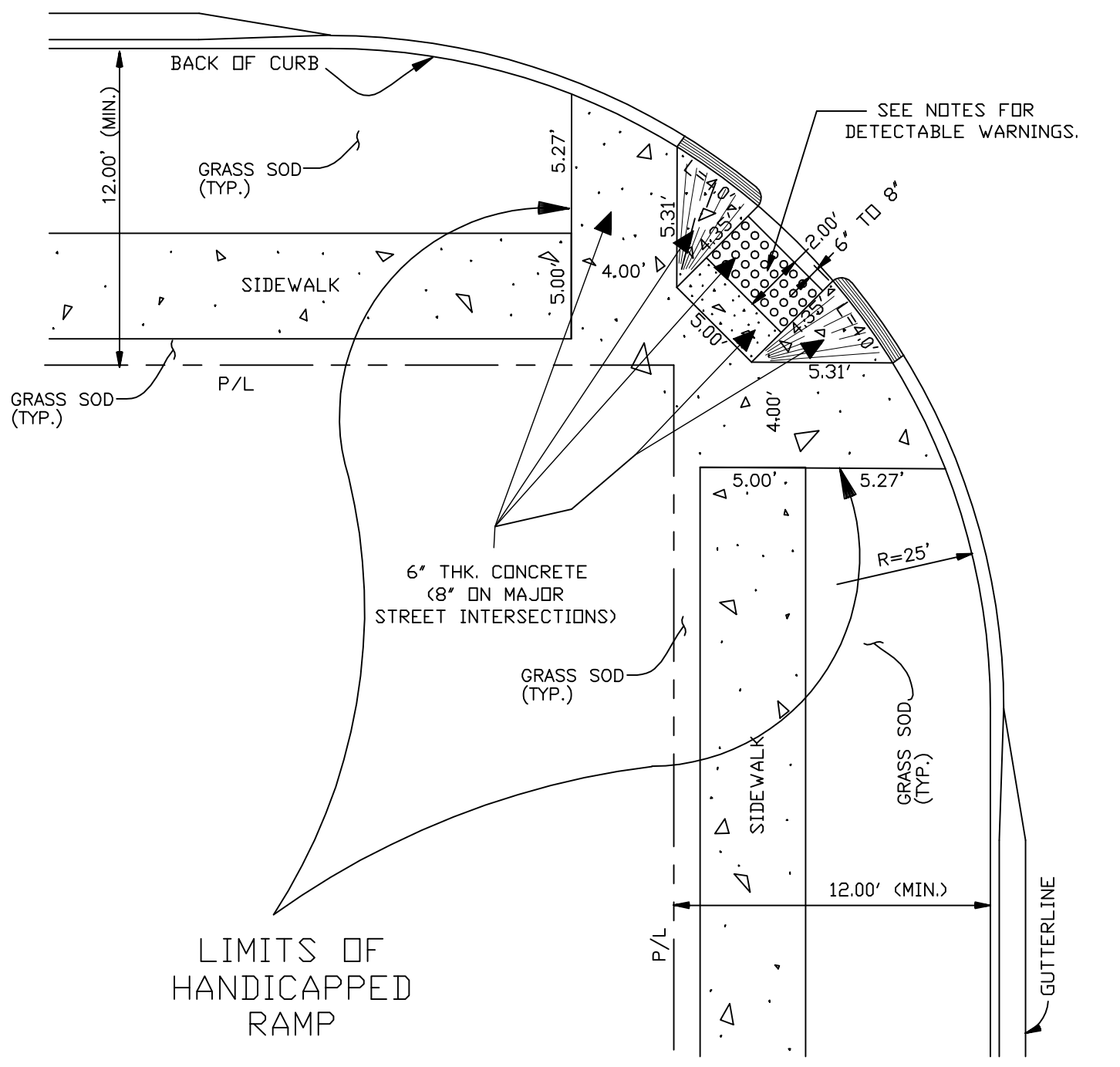

RAMP FOR THE HANDICAPPED
(CORNER RADIUS 25FT.)
N.T.S.

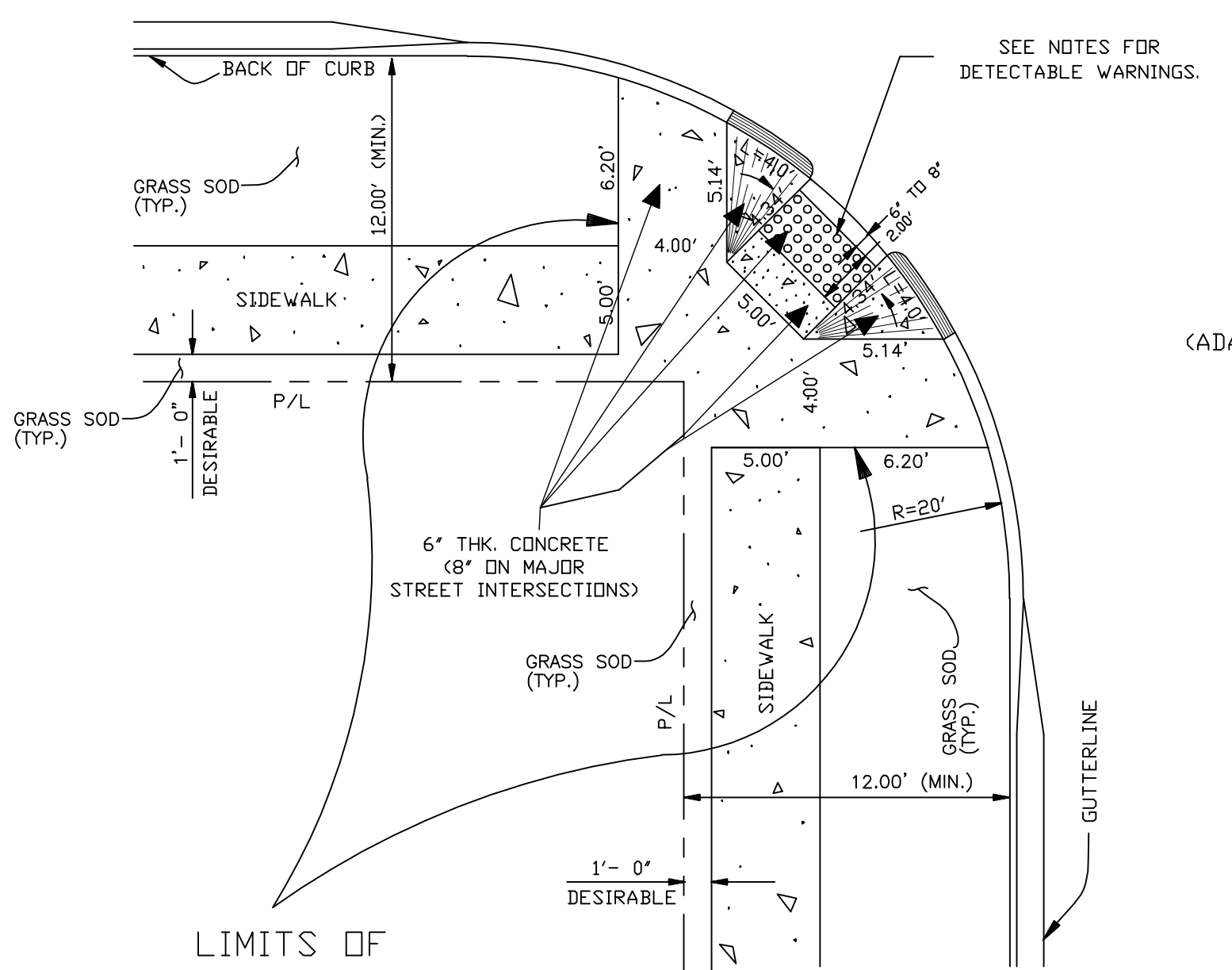

LIMITS OF HANDICAPPED RAMP
RAMP FOR THE HANDICAPPED
(CORNER RADIUS 20FT.)
N.T.S.

JEFFERSON PARISH DEPARTMENT OF ENGINEERING			
CURB RAMP FOR THE HANDICAPPED			
DRAWING TITLE			
DRAWN BY:	D.J.D.	DATE:	03/29/94
REVISOR BY:	H.J.W.	DATE:	07/26/02
REVISOR BY:	J.L.	DATE:	06/01/07
DRAWN BY:	C.H.S.	DATE:	02-17-09
REVISOR BY:	C.J.	DATE:	05-13-11
REVISOR BY:	C.J.	DATE:	09-24-15
REVISOR BY:	H.J.W.	DATE:	06/04/02
REVISOR BY:	P.D.	DATE:	03/04/04
REVISOR BY:	H.J.W.	DATE:	01/07/05
REVISOR BY:	J.L.	DATE:	05/12/08
REVISOR BY:	C.J.	DATE:	10-08-10
REVISOR BY:	J.W.	DATE:	07-24-14
REVISOR BY:	C.H.S.	DATE:	11-19-18
XTGS:	AUTOCAD 2000/LT. 2000	WIN:	HAND.DWG
FILE NUMBER:	2925C		